

Drehmoment / Torque  
 Elastomerring / elastomer ring  
 NBR 78 Shore A  
 $T_{KN} = 40 \text{ Nm}$   
 $T_{Kmax} = 80 \text{ Nm}$

| POLY-NORM                            | Gewicht [kg] | Massenträgheitsmoment [kgm <sup>2</sup> ] |
|--------------------------------------|--------------|---|
| Kuplungshälfte coupling half         | 1.447        | 0.001099                                  |
| Elastomerring Elastomer ring         | 0.012        | 0.000007                                  |
| Komplette Kupplung Complete coupling | 2.906        | 0.002205                                  |

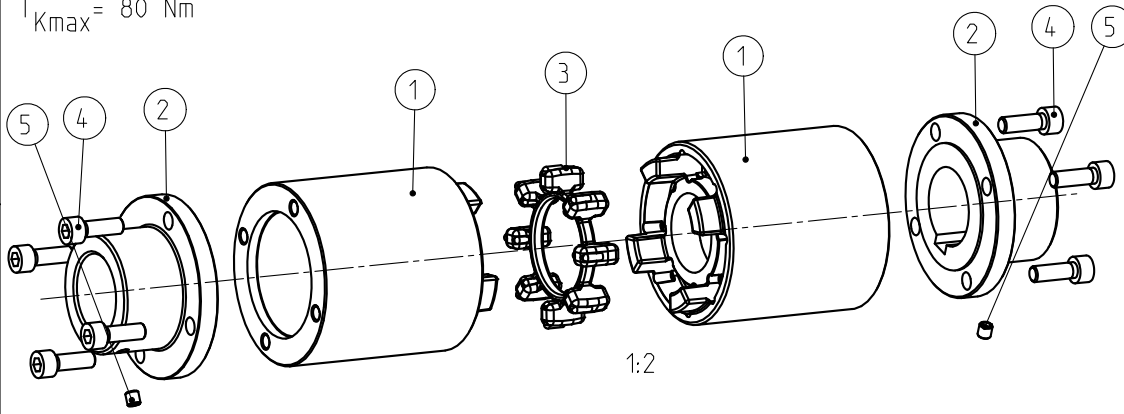

Schraubenanzugsmoment Teil 4 M6x18 DIN 912-12.9,  $T_A = 14 \text{ Nm}$   
 screw tightening torque part 4 M6x18 DIN 912-12.9,  $T_A = 14 \text{ Nm}$

|  |          |  |                        |                 |                         |
|--|----------|--|------------------------|-----------------|-------------------------|
| Oberflächengüte nach DIN ISO 1302 Reihe 2<br>Surface quality acc. to DIN ISO 1302 line 2 |          | Schutzvermerk ISO 16016 beachten<br>Note protection mark acc. to ISO 16016 |                        |                 |                         |
| Allgemeintoleranzen nach DIN ISO 2768 - mH<br>General tolerances acc. to DIN ISO 2768-   |          | Masstab Scale  | 1:1                    | Format DIN Size | A3                      |
| <b>POLY-NORM 28 (f. L=140)</b><br>Bauart AZR   |          |  |                        |                 |                         |
| gezeichnet drawn   |          | Werkstoff Material   | Teilnummer Part number | Kz              | Lfd.-Nr. Current number |
| Datum  | 20.08.04 | DIN  |                        | M               | 399365                  |
| Name   | BAJ      | Gewicht Weight   | 2.906                  |                 | 2                       |

