

Massenträgheitsmoment $J_{ges.} = 0.049166 \text{ kgm}^2$
 Mass moment of inertia $J_{ges.} = 0.049166 \text{ kgm}^2$

Drehmoment / Torque
 Zahnkranz / spider 95 Sh A-GS
 $T_{KN} = 625 \text{ Nm}$
 $T_{Kmax} = 1250 \text{ Nm}$

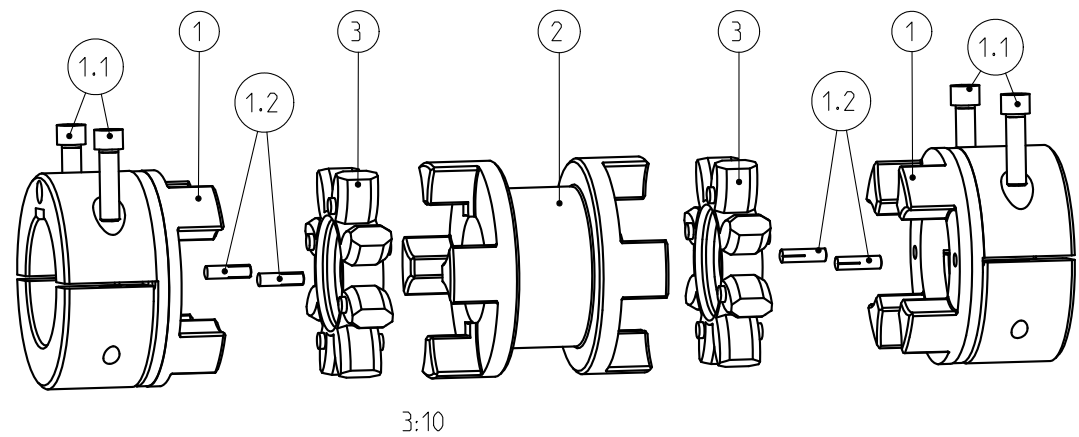

3:10

Passfedernuten nach DIN 6885 Bl.1 - JS9
 keyways acc. to DIN 6885 sheet 1 - JS9

zul. Radialverlagerungen ($\sim Kr$)	
allowable radial displacements ($\sim Kr$)	
bei $n = 1500 \text{ min}^{-1}$	bei $n = 3000 \text{ min}^{-1}$
at $n = 1500 \text{ rpm}$	at $n = 3000 \text{ rpm}$
$\sim Kr = 2.01 \text{ mm}$	$\sim Kr = 1.51 \text{ mm}$

Schraubenanzugsmoment (1.1) M12x45 DIN 912-12.9 $T_A = 120 \text{ Nm}$
 screw tightening torque (1.1) M12x45 DIN 912-12.9 $T_A = 120 \text{ Nm}$

Oberflächengüte nach DIN ISO 1302 Reihe 2 Surface quality acc. to DIN ISO 1302 line 2		Schutzvermerk ISO 16016 beachten Note protection mark acc. to ISO 16016	
Allgemeintoleranzen nach DIN ISO 2768 - mH General tolerances acc. to DIN ISO 2768-		Masstab Scale	11:20
		Format DIN Size	A3

ROTEX 65 - L=180
 ZS-DKM-H

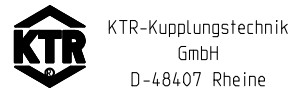

gezeichnet drawn	Werkstoff Material	Teilnummer Part number	Kz	Lfd.-Nr. Current number	Index Change
Datum 12.11.04	DIN		M	424571	0
Name HC	Gewicht Weight	16.786			